

DSL SETUP - Windows Vista

USER PROFILE: Stand-alone DSL modem with WIN Vista.

1. DSL modem type: proceed only after verifying that your DSL device is a stand-alone DSL modem.

IMPORTANT: These instructions do not apply if your device has “router functionality”.

2. Go the Windows Network and Sharing Center: right-click on **Network** icon found on the lower right side of the Windows Taskbar, then select **Network and Sharing Center**.
(Alternate: Start > Control Panel > Network and Internet > Network and Sharing Center)

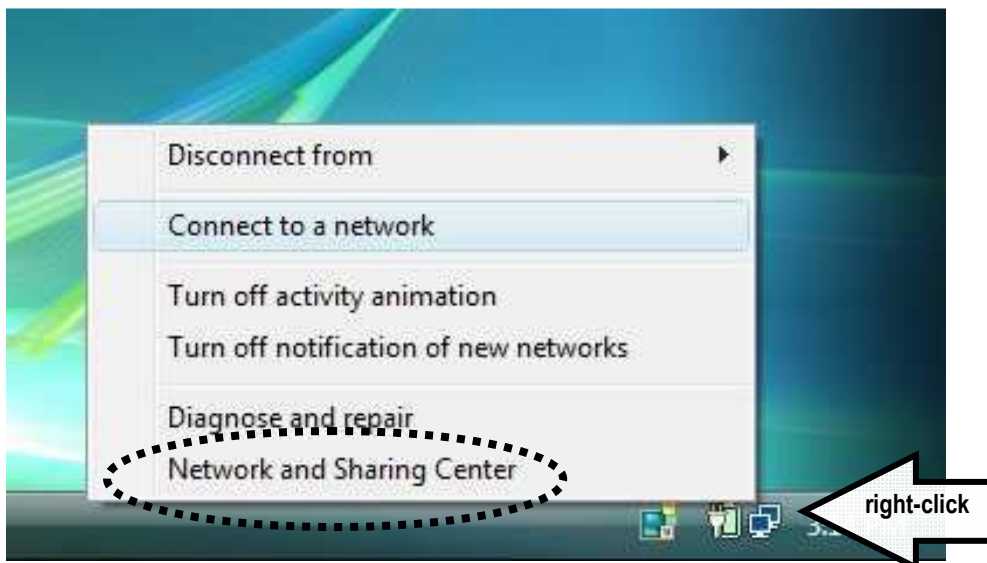

step 2: right click on the Network icon, select Network and Sharing Center

3. Click on Set up a connection or network.

4. Click on Connect to the Internet, then select Broadband (PPPoE).



step 4: select Broadband (PPoE)

5. ISP information: enter your **TKSSurf! username** and **password** exactly as it appears on your **TKSSurf! Internet Access Package**, name your DSL connection **TKSSurf**. Click **Connect** to continue.

EXAMPLE:

TKSSurf! **Username** (8-digits plus domain name): **12345678@tk-net.com**

TKSSurf! **Password** (6-digits): **123456**

Connection name: TKSSurf

Note: If you would like others to be able to use this connection on the computer, checkmark: **Allow other people to use this connection**.

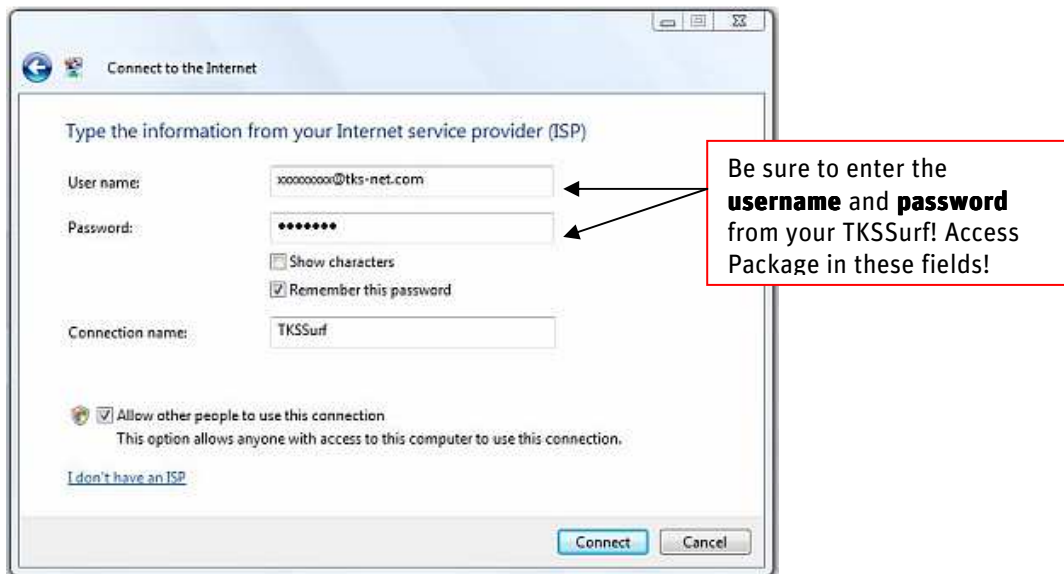

step 4: ISP information

6. Vista OS will now test your Internet connection, afterwards click **Close** to finalize the setup wizard.



step 5: connection test

7. A new window will prompt you **Set Network Location**, select **Home** to continue, then click **Close** to exit the Set Network Location window. You're done!

CONNECTING TO THE INTERNET

To get online, click the Windows **Start** button, click **Connect to**, and then click on the **TKSSurf!** connection you just created.